

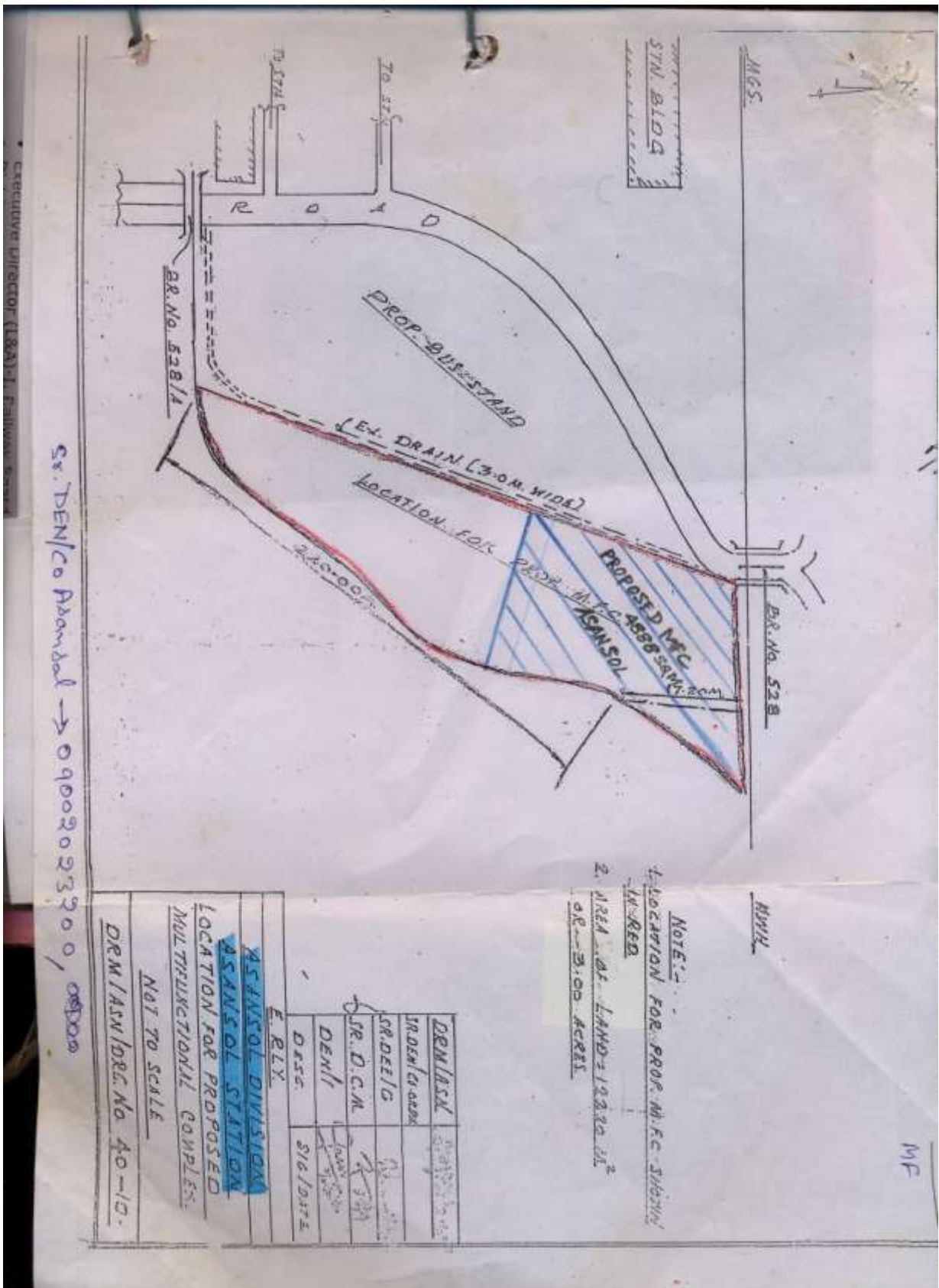

2. **Asansol:**—The details of the Site is as below:-:

Land Area	4888 Sqm.
Built up Area	7821 Sqm, but can be increased to 10998 Sqm, on additional payment on prorata basis.
<b>The Site is bounded by:-</b>	
North:	Railway Tracks & Station Building
West:	Bus Stand
South:	Railway Tracks
East:	Railway Tracks

**Site plan:**—The Site Plan is not to the Scale.



Handed C

Eastern  
Asansol

*Signature*  
9.8

सहायक अभियन्ता (मुख्यालय)  
डू रो, आसनसोल  
Asstt. Engineer (HQ)  
E. Rly. Asansol

Taken Over  
Eastern Rly.  
Asansol Di.

*Signature*  
प्रबंधक/परियोजना/Manage  
रेल भूमि विकास प्राधिकरण  
Rail Land Development  
रेल भू-माल्य, भारत सरकार का वरिष्ठ  
A Statutory Authority under Ministry  
नई दिल्ली/New Delhi

Taken over from RLDA

Payel Shopping Complex Private Limited

*Signature*  
S. B. Goyal Road  
Asansol-01  
Director

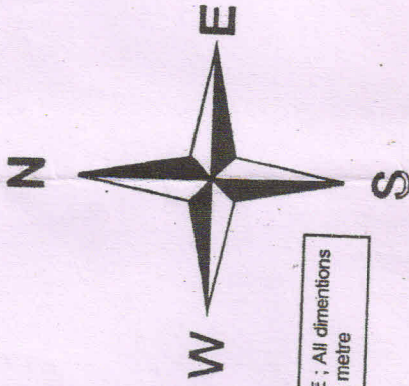

NOTE : All dimensions  
are in metre

DRM/ASN		
SR.DEN(C)		
SR.DEE/G		
SR.DSTE		
SR.DCM		
DEN/1	<i>Signature</i> 19/8/17	
DESIGN		SIG/DATE

E.RLY ASANSOL DIVISION ASANSOL STATION
DEVELOPMENT OF MFC AT ASANSOL
NOT TO SCALE
DRM/ASN/DRG.NO. 83-2017

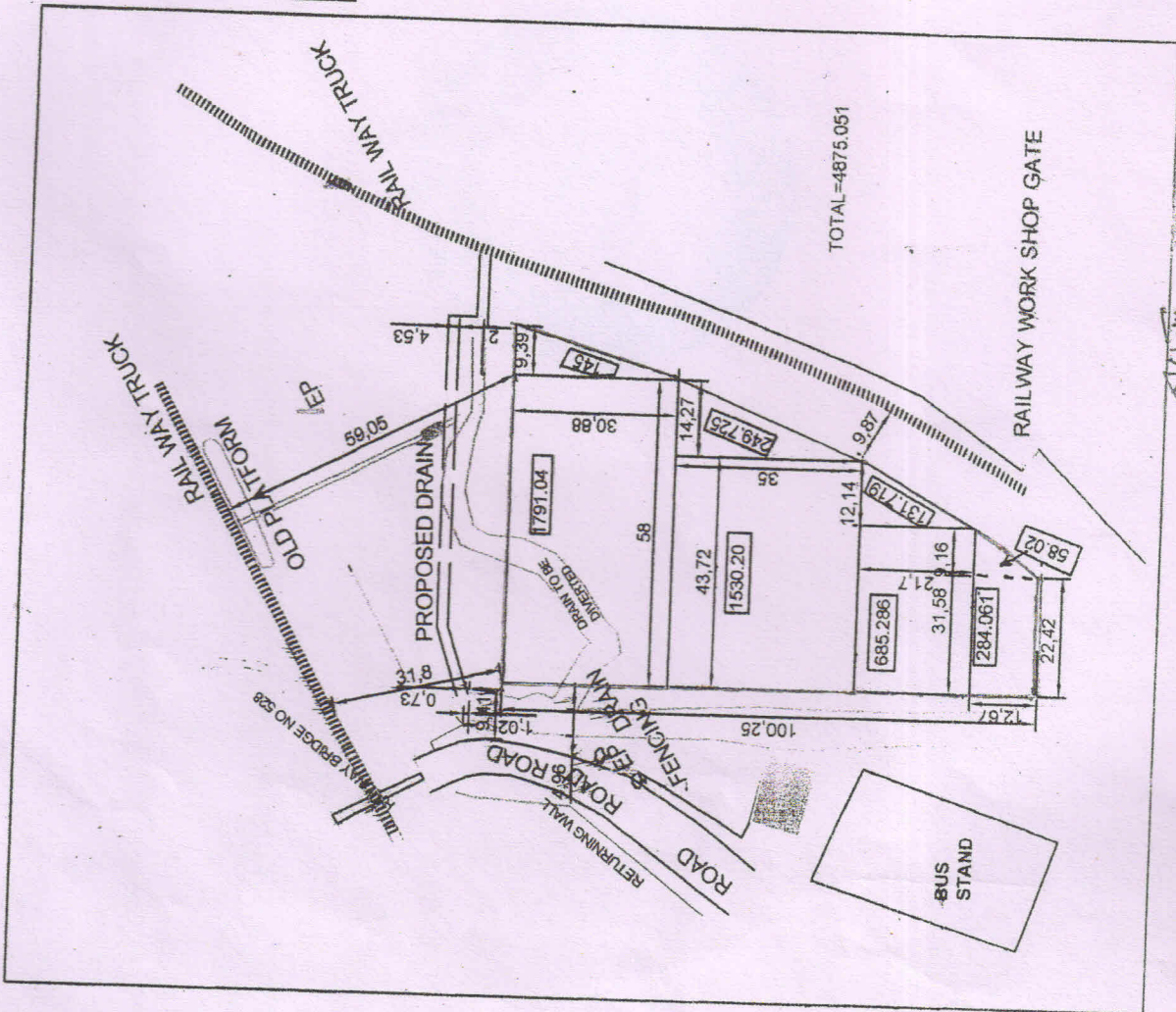

ALCHANN  
09/08/17  
SSE (NI)/ASN  
AEN/HQ/ASN

